

1 Front view



Power supply unit for 24V=



2 Features

- Input voltage 230V~
- Output voltage 24V=
- Required for example for AHC-XP, ECA970, TRH-XP, TRS and IMR950

Writing conventions

Symbol	Meaning
 CAUTION!	Avoid the described hazard: otherwise minor or medium physical injury or damage to property will result.
 WARNING!	Avoid the described hazard: otherwise there is danger from electric voltage that could lead to death or serious physical injury.

For your safety

For safe operation and to avoid personal injury and equipment damage through operating error, always read these instructions, become familiar with the device, and follow all safety instructions on the product and in this document, as well as the safety guidelines of Wurm GmbH & Co. KG Elektronische Systeme. Keep these instructions ready to hand for quick reference and pass them on with the device if the product is sold.

Wurm GmbH & Co. KG Elektronische Systeme accepts no liability in case of improper use or use for other than the intended purpose.

Target group	These instructions are intended for "service technicians".
Intended use	The SNT24 is intended as a power supply unit.



WARNING!

Danger to life from electric shock and/or fire!

- Switch off the power to the entire plant when installing, wiring or removing! Otherwise a mains voltage and/or external voltage may still be present even if the control voltage is switched off!
- The wiring of the device should be carried out only by a qualified electrician!
- Use only the correct tools for all work!
- Check all wiring after connection!
- Take note of the maximum loads on all connections!
- Never expose the device to moisture, for example due to condensation or cleaning agents!
- Take the device out of operation if it is faulty or damaged and is therefore compromising safe operation!
- Do not open the device!
- Do not repair the device yourself! If required, send it in for repair with an exact description of the fault!

Validity of the documentation

Date	
2018-01	Documentation status

This document automatically ceases to be valid if a new technical description is issued.

Manufacturer: Wurm GmbH & Co. KG Elektronische Systeme, Morsbachtalstraße 30, D-42857 Remscheid

For further information, see our website at www.wurm.de

3 Connection diagram

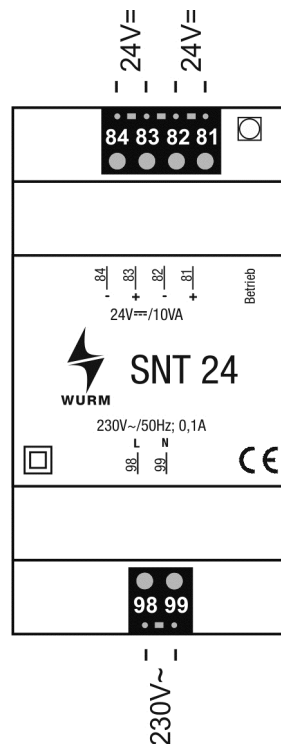

Fig. 1: Connection diagram

4 Installation

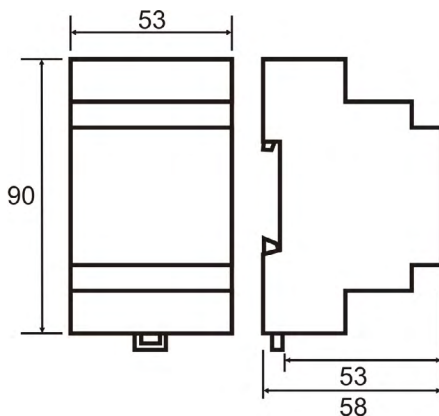

Fig. 2: Dimensions

This device is designed for top-hat rail installation. The housing is a standard size and is also suitable for installation in fuse boxes, distribution switch boxes or electric boxes of refrigeration units.

The devices can be positioned immediately next to one another and without gaps.

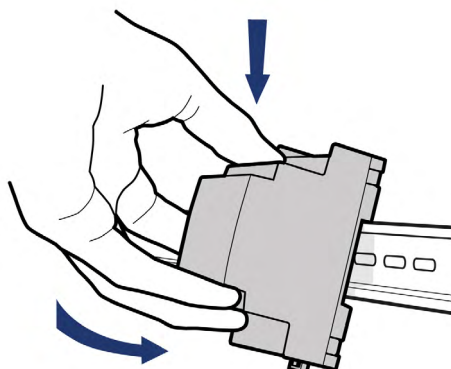

Fig. 3: Top-hat rail installation

Install the module in the vicinity of the controlling field module.

Place the module with the upper guide edge on the top-hat rail. Then press it gently downward until it engages with the fastening safety catch on the rail.

5 Technical data

Power supply	230V~, +10% / -20%
Output voltage	24V=, controlled ($\pm 5\%$)
Output current	Max. 410mA, temperature controlled, not reversible
Power output	10VA
Ripple	<5%
Dimensions	(WxHxD) 53 x 90 x 58mm (DIN 43880)
Electrical connection	Push-in terminals 2.5mm ²
Fastening	Top-hat rail TH 35-15 or TH 35-7.5 (DIN EN 60715)
Ambient temperature	Operation: 0...+55°C, storage: -25...+70°C
Weight	About 100g
CE conformity	– 2014/35/EU (Low Voltage Directive) CE
EAC conformity	– TR CU 004/2011 EAC
	RoHS II